

Patiflor Pot

Patiflor is a **wheel-shaped pot** with a one-sided indentation. It has **several uses**: it can serve as a loose-standing flower pot, act as a kind of flower 'sound barriers' in busy streets or be used to construct retaining walls. The **rough structure** perfectly fits **backyard gardens and urban green spaces**.

It is also available in a **reduced size version**, as **Patiflor mini**.



Color chart

Pot surface



graphite

gray



Attention: Colours with a phone icon: Only on order product.

Recommendations and information:

Installation in accordance with the construction practice. In the case of strengthening slopes of embankments – construction of Agaflo layers with 1/2 width shift. In the case of construction retaining wall over 1m high – it should be only used as the lost formwork for footing the reinforcement inside and filling with concrete. Quality of concrete, the amount of reinforcement and construction of bench foundation must be specified on a technical design.

The shape allows any arrangement with exact matching to each other.

Bevel: non-beveled

Spacers: spacers-free – shape allows precise adjustment to each other

Production: made with the use of the one-ply technology

Shapes and dimensions

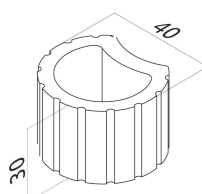
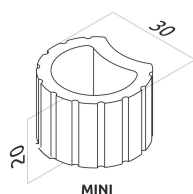

Product details

- Number of elements in the system:** 1
- Appearance:** the shape of a circle with a single incision, 2 sizes
- Shape:** bottomless
- Designation:** planter, walls and pillars, reinforcement of slopes, flower beds, flower beds
- Material:** vibro-pressed concrete
- Usage:** outdoor

Logistic data

Pallet weight [kg]	Number of layers per pallet
Patiflor: 700	Patiflor: 3
Patiflor mini: 630	Patiflor mini: 5
Number of pieces per pallet	
Patiflor: 24	
Patiflor mini: 60	

Attention: For technological reasons product's weight may change.

See the product online on your smartphone

